

# HAYWARD LOGISTICS CENTER

2701 WEST WINTON AVE, HAYWARD, CA 94545

Q3 2019 Completion



## Premier I-880 Market Location

±506,925 sq. ft. Crossdock Logistics Facility  
Combining State Of The Art Features With A  
Modern Campus Environment on 23.4 Acres

- Divisible
- At the Epicenter of the region- 40 min to 80% of the Bay Area
- Largest contiguous rooftop available from Oakland to Newark
- 17 miles to the Port of Oakland
- Premier Logistics Location only 1.6 Miles to I-880 and 2.4 Miles to Highway 92, two of the Bay Area's Busiest connector arteries.

OWNED BY:



[blackcreekgroup.com](http://blackcreekgroup.com)

**CBRE**

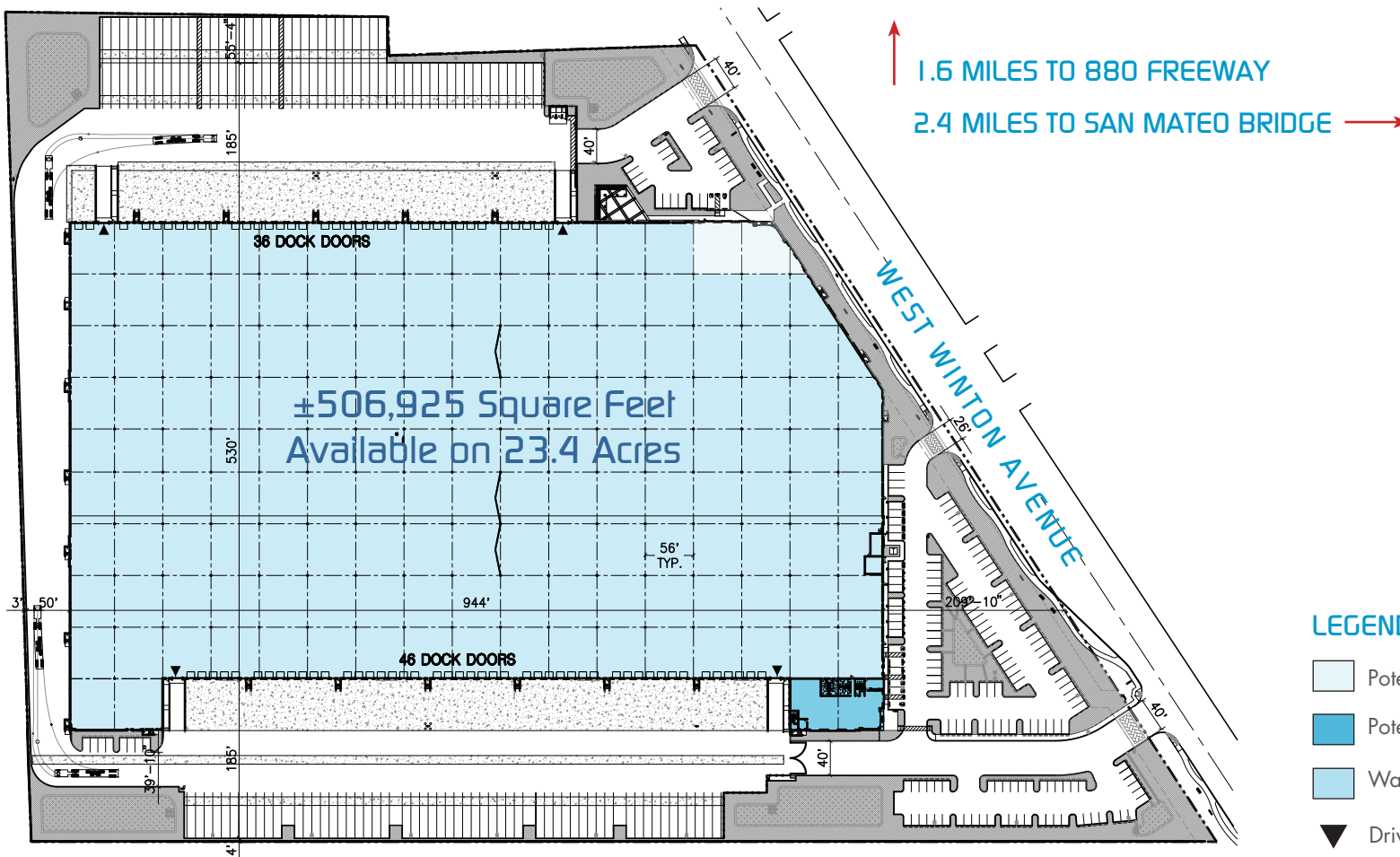

### LEGEND

-  Potential Office
-  Potential Office w/Mezz
-  Warehouse
-  Drive-Thru Door

## Features

- 36' Clear Height
- ESFR Fire Sprinklers
- 82 Dock Doors
- 185' truck courts
- 146 Trailer Parking
- 188 Car Parking
- 4,000 Amps Power with 8,000 Amp capacity
- Fully Secured, Fenced and Paved
- 4 Drive In Doors
- 60' x 56' Column Width
- Skylights throughout
- Solar Ready Roof
- Drive Around Access

OWNED BY:



blackcreekgroup.com

# CORPORATE NEIGHBORS



SITE

CBRE

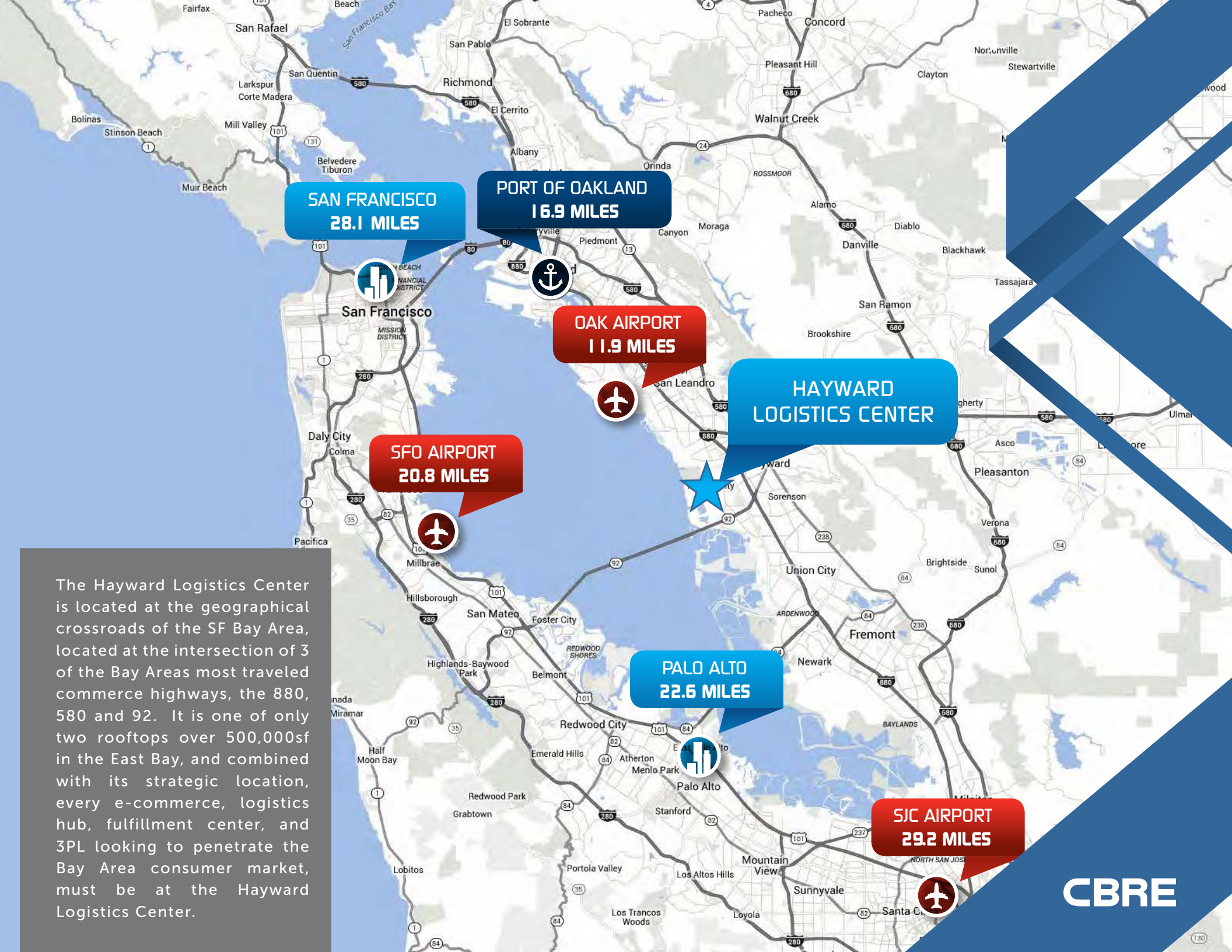

**SAN FRANCISCO**  
28.1 MILES

**PORT OF OAKLAND**  
16.9 MILES

**OAK AIRPORT**  
11.9 MILES

**SFO AIRPORT**  
20.8 MILES

**HAYWARD LOGISTICS CENTER**

**PALO ALTO**  
22.6 MILES

**SJC AIRPORT**  
29.2 MILES

The Hayward Logistics Center is located at the geographical crossroads of the SF Bay Area, located at the intersection of 3 of the Bay Areas most traveled commerce highways, the 880, 580 and 92. It is one of only two rooftops over 500,000sf in the East Bay, and combined with its strategic location, every e-commerce, logistics hub, fulfillment center, and 3PL looking to penetrate the Bay Area consumer market, must be at the Hayward Logistics Center.



OWNED BY:



**BLACK CREEK GROUP**

[blackcreekgroup.com](http://blackcreekgroup.com)

## Contact Info:

### **KEVIN HATCHER**

Senior Vice President  
Lic. 01495631  
+1 510 874 1939  
[kevin.hatcher@cbre.com](mailto:kevin.hatcher@cbre.com)

### **ROBERT FERRARO**

Senior Vice President  
Lic. 00949584  
+1 510 874 1910  
[bob.ferraro@cbre.com](mailto:bob.ferraro@cbre.com)

### **MICHAEL BARRY**

Senior Vice President  
Lic. 000950054  
+1 510 874 1926  
[michael.barry@cbre.com](mailto:michael.barry@cbre.com)

© 2019 CBRE, Inc. All rights reserved. This information has been obtained from sources believed reliable, but has not been verified for accuracy or completeness. Any projections, opinions, or estimates are subject to uncertainty. The information may not represent the current or future performance of the property. You and your advisors should conduct a careful, independent investigation of the property and verify all information. Any reliance on this information is solely at your own risk. CBRE and the CBRE logo are service marks of CBRE, Inc. and/or its affiliated or related companies in the United States and other countries. All other marks displayed on this document are the property of their respective owners. Photos herein are the property of their respective owners and use of these images without the express written consent of the owner is prohibited. PMSstudio\_February2019

**CBRE**